



PROTOTYPETM
RACING PARTS

2019 - 2020

CHAMPIONS ARE



**Carlos
Coloma**

3rd Olympic Games Rio 2016
Spanish Champion 2016
13th UCI Ranking 2016



**Catriel
Soto**

Panamerican MTB Champion 2016
Argentine Champion 2009-2016
Olympic Athlete



**David
Rosa**

7x Portuguese XCO Champion
15th European XCO Championship 2016
Olympic Athlete



**David
Valero**

7th UCI Ranking 2016
8th MTB World Championship 2016
2nd Spanish XCO Championship 2016



**Martina
Berta**

Italian XCO Champion 2016
2nd MTB World Championship 2016
XCO World Champion 2015

POWERED BY PROTOTYPE



**Marga
Fullana**

XCO World Champion 2015-2016
European Champion Duathlon CR
Spanish Champion Duathlon CR

**Mário
Costa**

6x Portuguese XCO Champion
5x Taça de Portugal Winner
Portugal Tour Winner

**Pablo
Rodriguez**

3rd World Cup Andorra 2016
3rd Spanish Championship 2016
10th MTB World Championship 2016

WE'RE
AMONGST
THE BEST

Rio2016

BRONZE MEDAL RIO 2016



5 WORLD
CHAMPIONSHIPS



4 EUROPEAN
CHAMPIONSHIPS



MORE THAN 50
NATIONAL CHAMPIONS



GUINNESS WORLD
RECORD



27 ATHLETES IN
UCI WORLD CUP

PROTOTYPETM RACING PARTS

COMPANY

About us

We test what we do!

The performance, efficiency and reliability are our base work priorities. Though lightweight, the stiffness of PROTOTYPE products is computationally tested to the limit, proven by elite athletes who have won more than 40 national and international titles, including the World Champion.

PROTOTYPE is totally committed to an efficient aftersales service, always giving technical solutions to allow a practical and simplified maintenance.

Our products have a reason to exist because we know where we are and where we want to go.

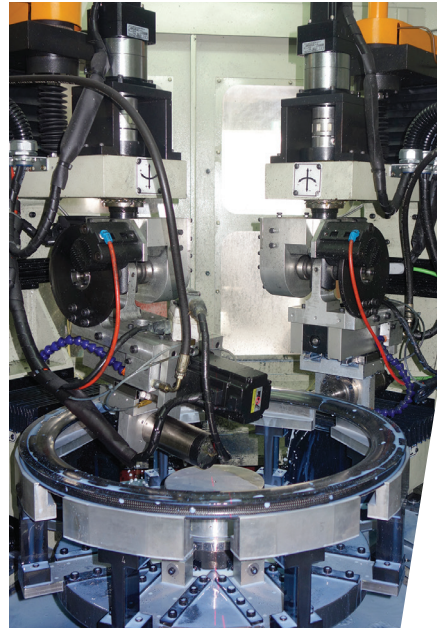

High precision drilling machine to locate and place the spoke holes to the exact position and angle.

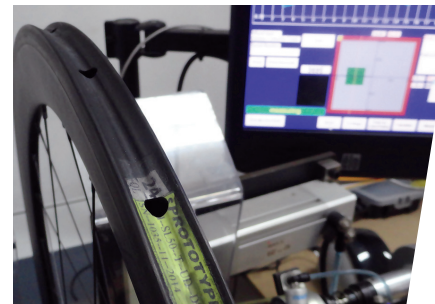
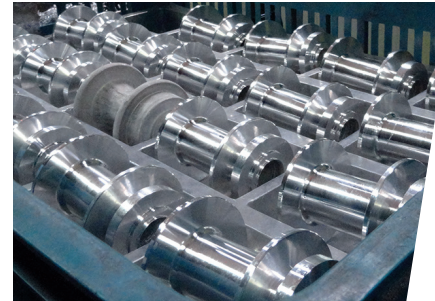

Controlled wheel truing with full tension and tolerance analysis and register.

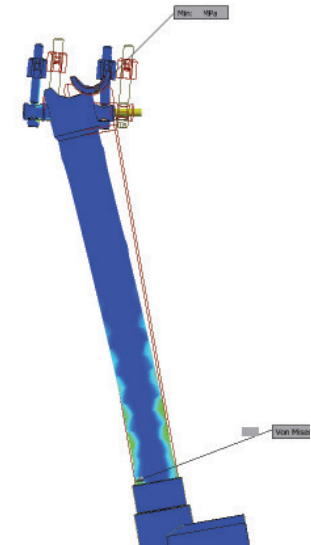

Finite element analysis (FEA) to calculate stresses and displacements of component displacements, strains under internal and external loads.

With the analysis results, we can catch design flaws and optimize features at the drawing stage.

All wheels are built with unmatched attention to detail, we use high-precision tools, specially designed for us. We can offer a ride quality and durability that cannot be matched by a stock machine-built set.

Ivo Santos

Prototype Technical Department



A full-page background image of a mountain biker in a blue and black jersey riding a Prototype mountain bike through a forest. The biker is wearing a helmet and gloves, and the bike has 'PROTOTYPE' and '29 TEAM' written on the wheels. The scene is set in a wooded area with many trees and a dirt path.

WHEELS MTB

“Amazing wheels, lightweight, stiff and very trustable. There’s nothing similar in 29. The 27 width allows to low the tire pressure without taking risk.

Carlos Coloma

Bronze Medal Olympic Games RIO 2016

C A R B O N

WHEELS MTB
WORLD CUP2019 WORLD
CHAMPION

RIM Detail

WIDER
32mm
HooklessReference weight:
Clincher: 29" Boost - 1420gr

MSRP: 1.750 €

WHEELS MTB TEAM

C A R B O N

OLYMPIC GAMES
BRONZE MEDAL
RIO 2016

2017 WORLD
CHAMPIONSHIP

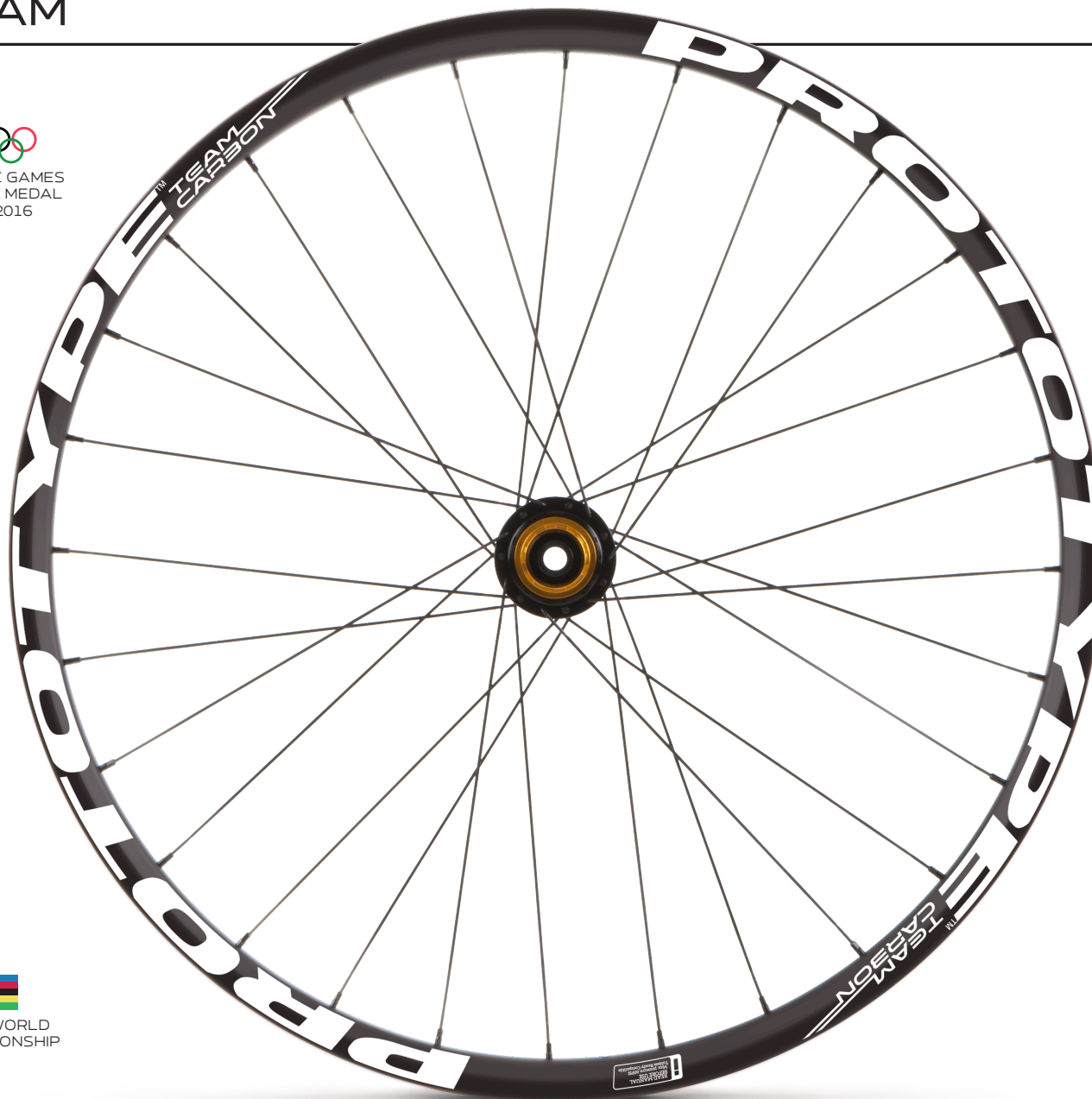

RIM Detail

WIDER
30mm
Hookless



Reference weight:
Clincher: 29" Boost - 1400gr

MSRP: 1.490 €

C A R B O N



Reference weight:
Clincher: 29" Boost - 1230gr

MSRP: 1.390 €

WHEELS MTB
ZERO

C A R B O N

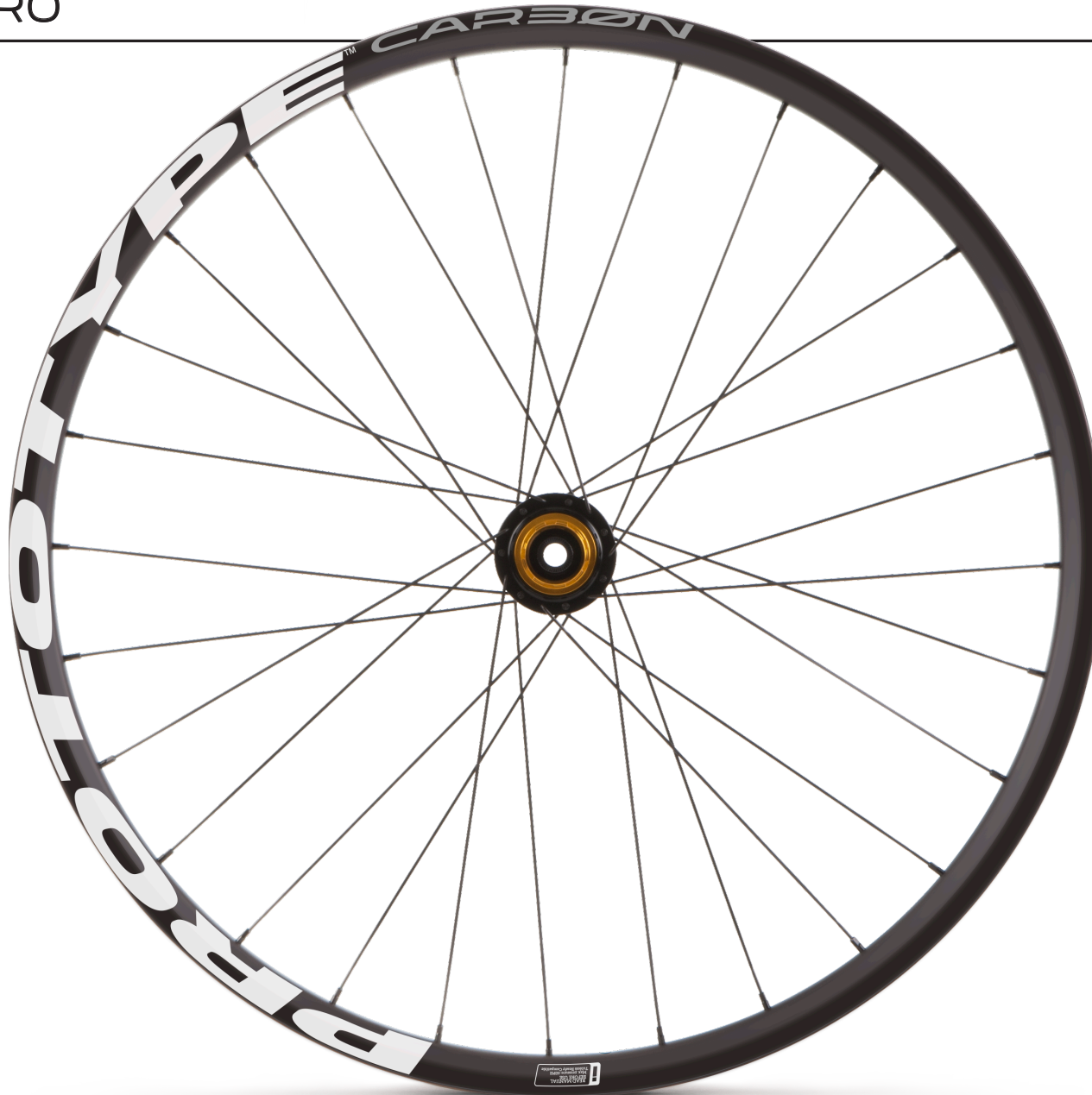

Reference weight:
Clincher: 29" Boost - 1560gr

MSRP: 990 €

C A R B O N

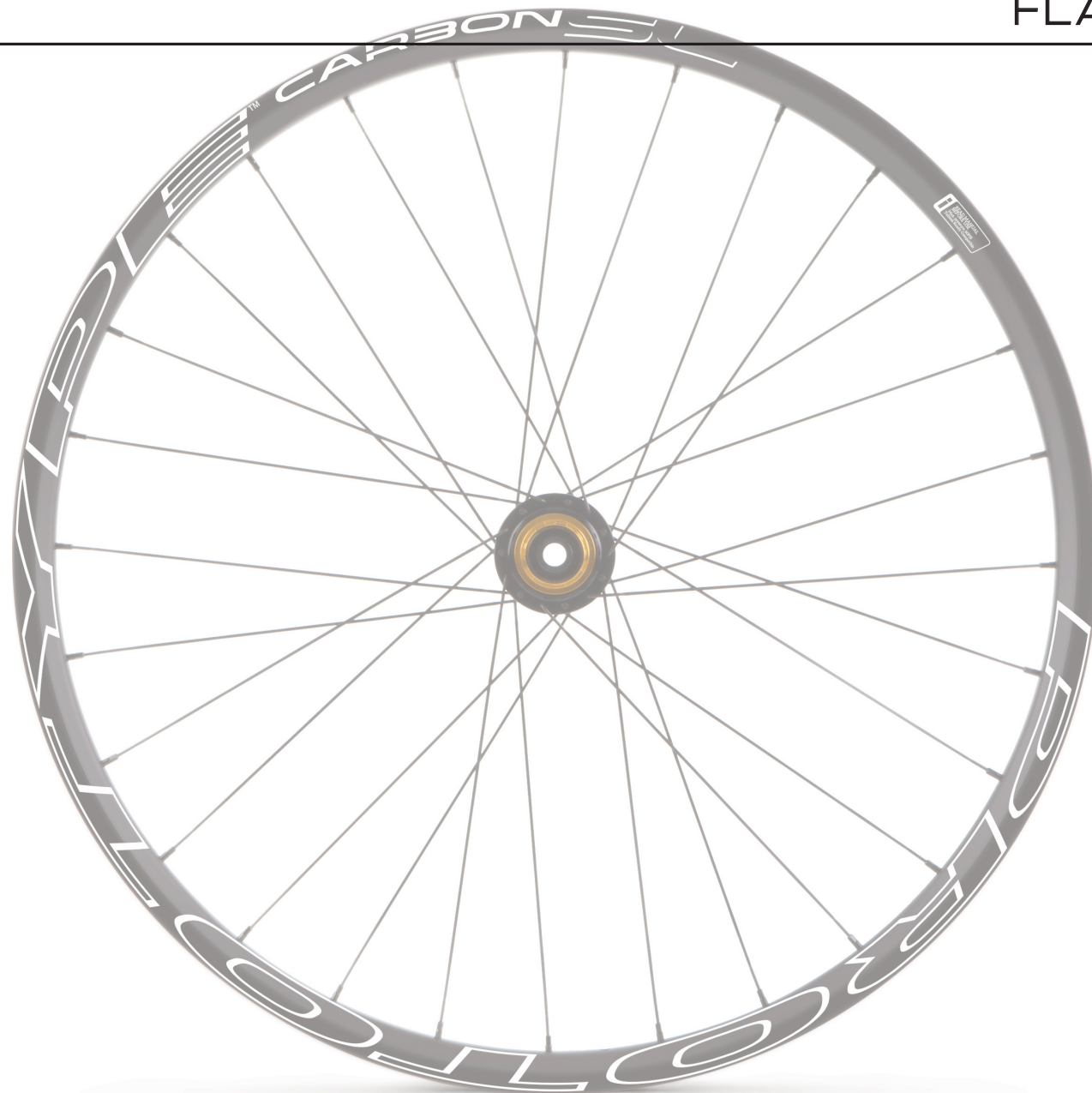

Reference weight:

Clincher

29" - 1430gr

MSRP: 830 €

WHEELS MTB
ZENITH TEAM

ALUMINIUM



RIM Detail

WIDER
28mm
Hookless



Reference weight:
Clincher: 29" Boost - 1490gr

MSRP: 840 €

ALUMINIUM

WHEELS MTB
ZENITH



2016 WORLD
CHAMPIONSHIP



Reference weight:
Clincher: 29" Boost - 1460gr

MSRP: 685 €

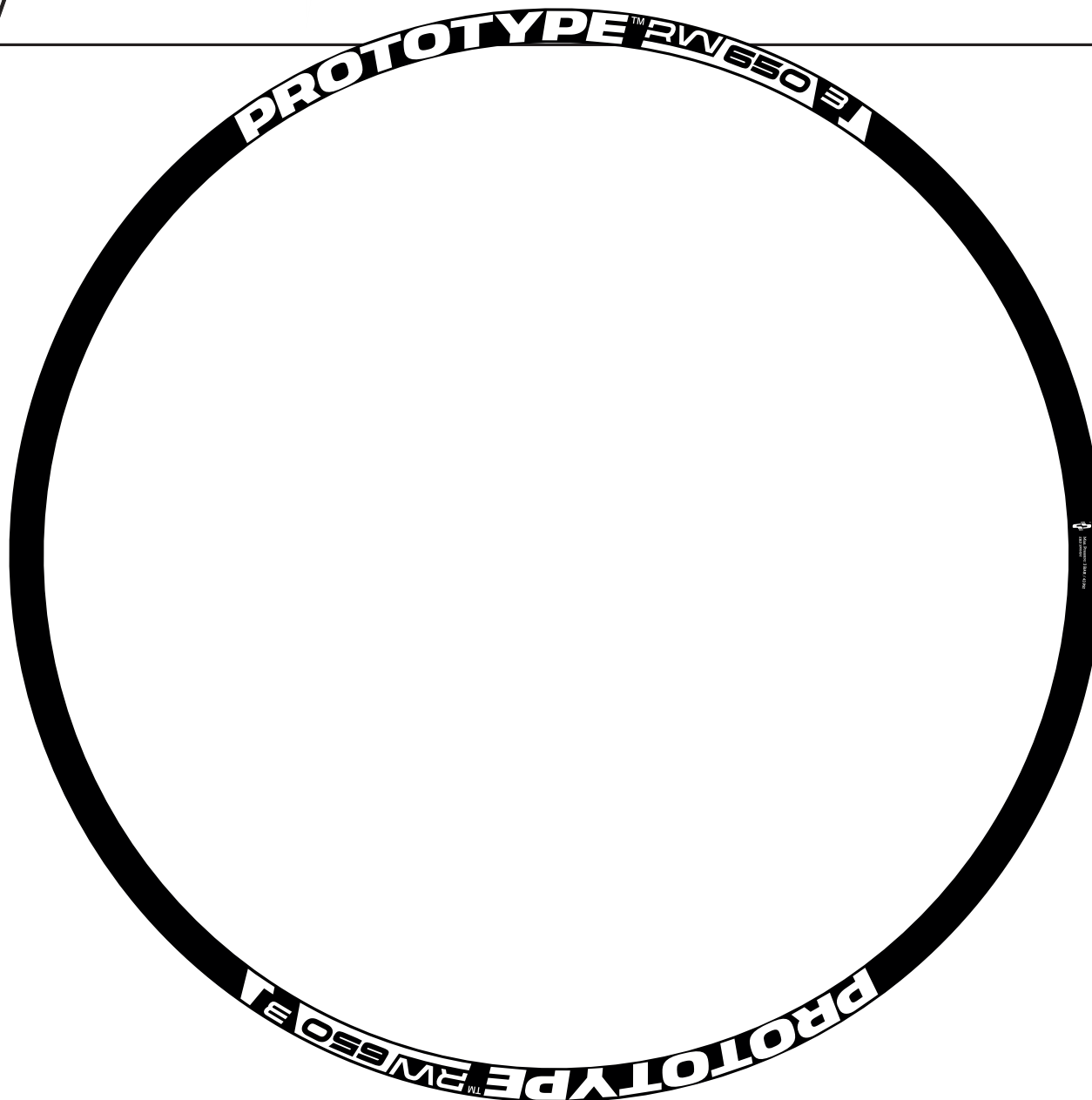

HUB Detail



RIM Detail



Reference weight:
Clincher
 29" -1660gr | 650b - 1610gr
 MSRP: 485 €

ALUMINIUM

HUB Detail

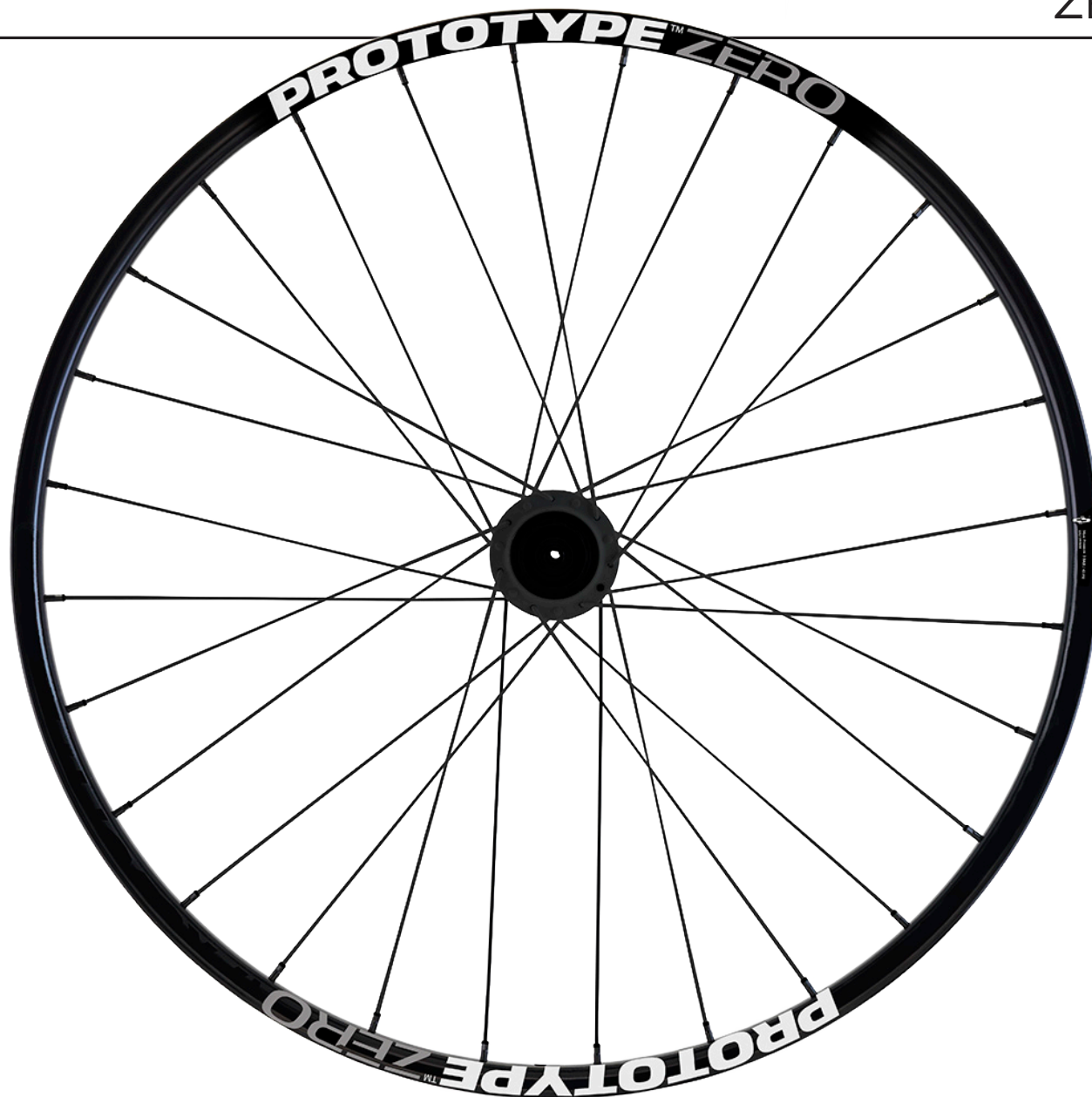

Reference weight:
Clincher: 29" Boost - 1720gr

MSRP: 385 €

WHEELS MTB FLASH

ALUMINIUM

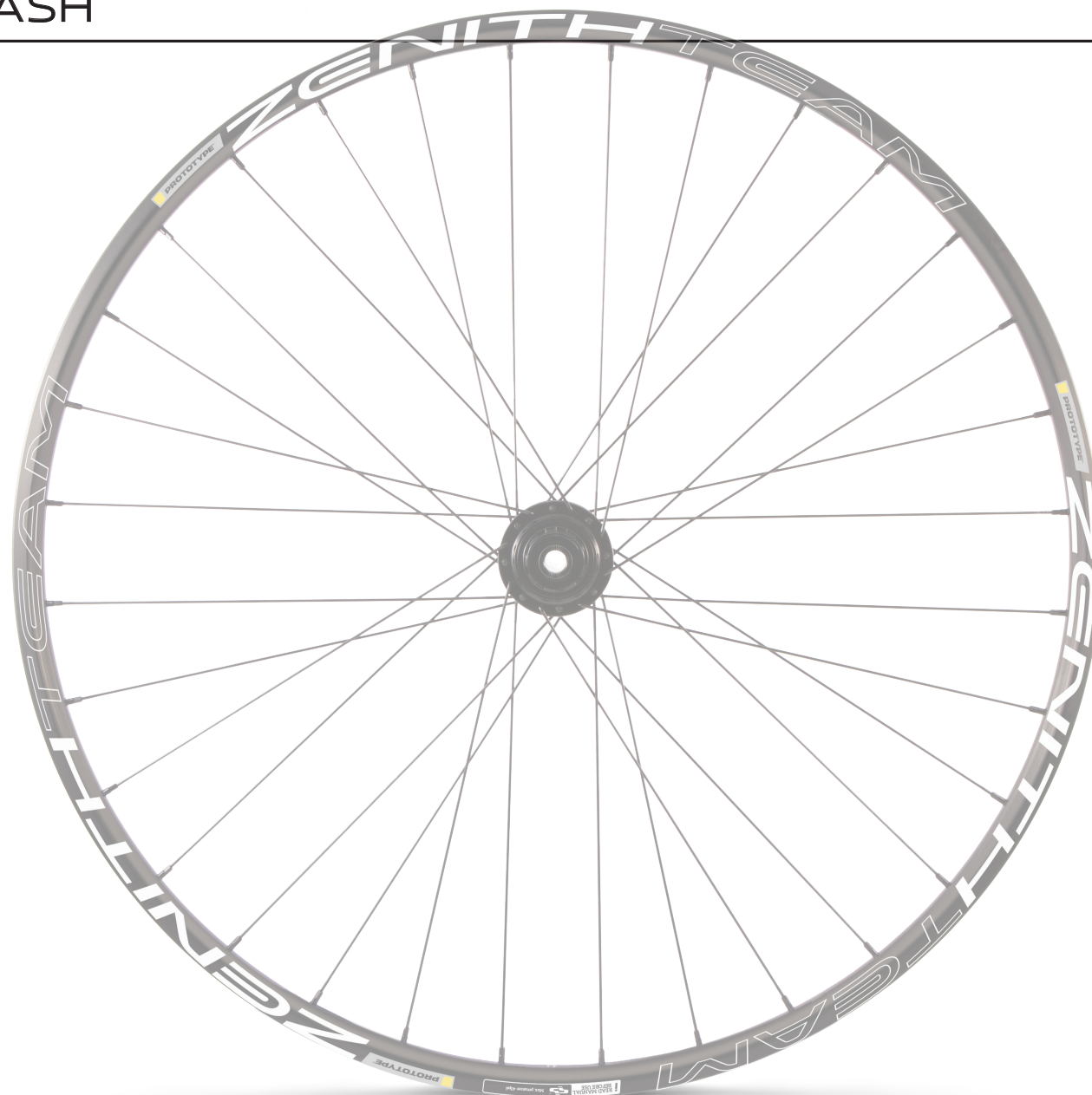

Reference weight:

Clincher

29" - 1430gr

MSRP: 830 €

WHEELS ROAD

All wheels are build with unmatched attention to detail, we use high-precision tools, specially designed for us. We can offer a ride quality and durability that cannot be matched by a stock machine-built set.

Ivo Santos

Prototype Technical Department



WHEELS ROAD
PROTOUR DISC AL

ALUMINIUM



HUB Detail



Reference weight:
Clincher: 1560gr

MSRP: 545 €

C A R B O N

WHEELS ROAD
PROTOUR DISC 3

HUB Detail



Reference weight:
Clincher: 1425gr

MSRP: 1270 €

WHEELS ROAD PROTOUR 5

C A R B O N



2016 WORLD
CHAMPIONSHIP



HUB Detail



Reference weight:
Clincher: 1560gr

MSRP: 1270 €

WHEELS ROAD PROTOUR 2 SL

C A R B O N

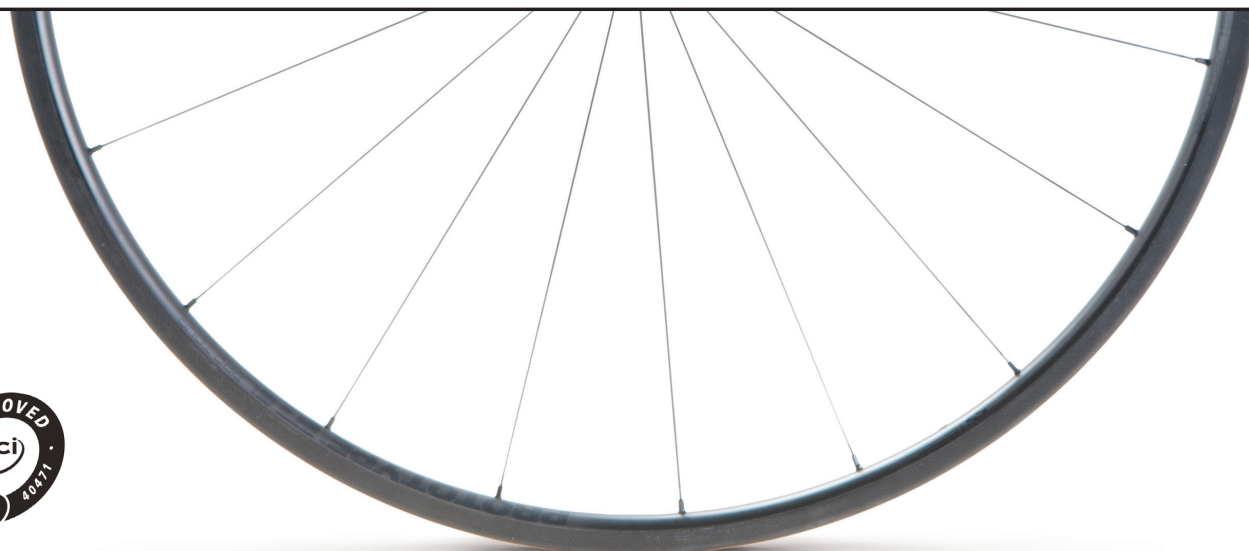

HUB Detail



Reference weight:

Tubular: 990grMSRP: 1590 €

PROTOUR 3 SL



OPTION Color



Reference weight:

Clincher: 1300gr | **Tubular:** 1080grMSRP: 1590 €

C A R B O N

WHEELS ROAD
PROTOUR 5 SL

HUB Detail



THE TEAMS CHOICE



Reference weight:
Clincher: 1380gr | Tubular: 1250gr
MSRP: 1590 €



WHEELS ROAD PROTOUR 3

C A R B O N



HUB Detail



Reference weight:
Clincher: 1420gr
Tubular: 1240gr

MSRP: 1270 €

CARBON

WHEELS ROAD
PROTOUR 5

HUB Detail



THE TEAMS CHOICE



Reference weight:
Clincher: 1500gr
Tubular: 1390gr

MSRP: 1270 €



WHEELS ROAD
PROTOUR CA

CARBON & ALUMINIUM



HUB Detail



Reference weight:

Clincher: 1740gr

MSRP: 845 €

ALUMINIUM

WHEELS ROAD
PROTOUR AL

HUB Detail



THE TEAMS CHOICE



Reference weight:

Clincher: 1620gr

MSRP: 395 €

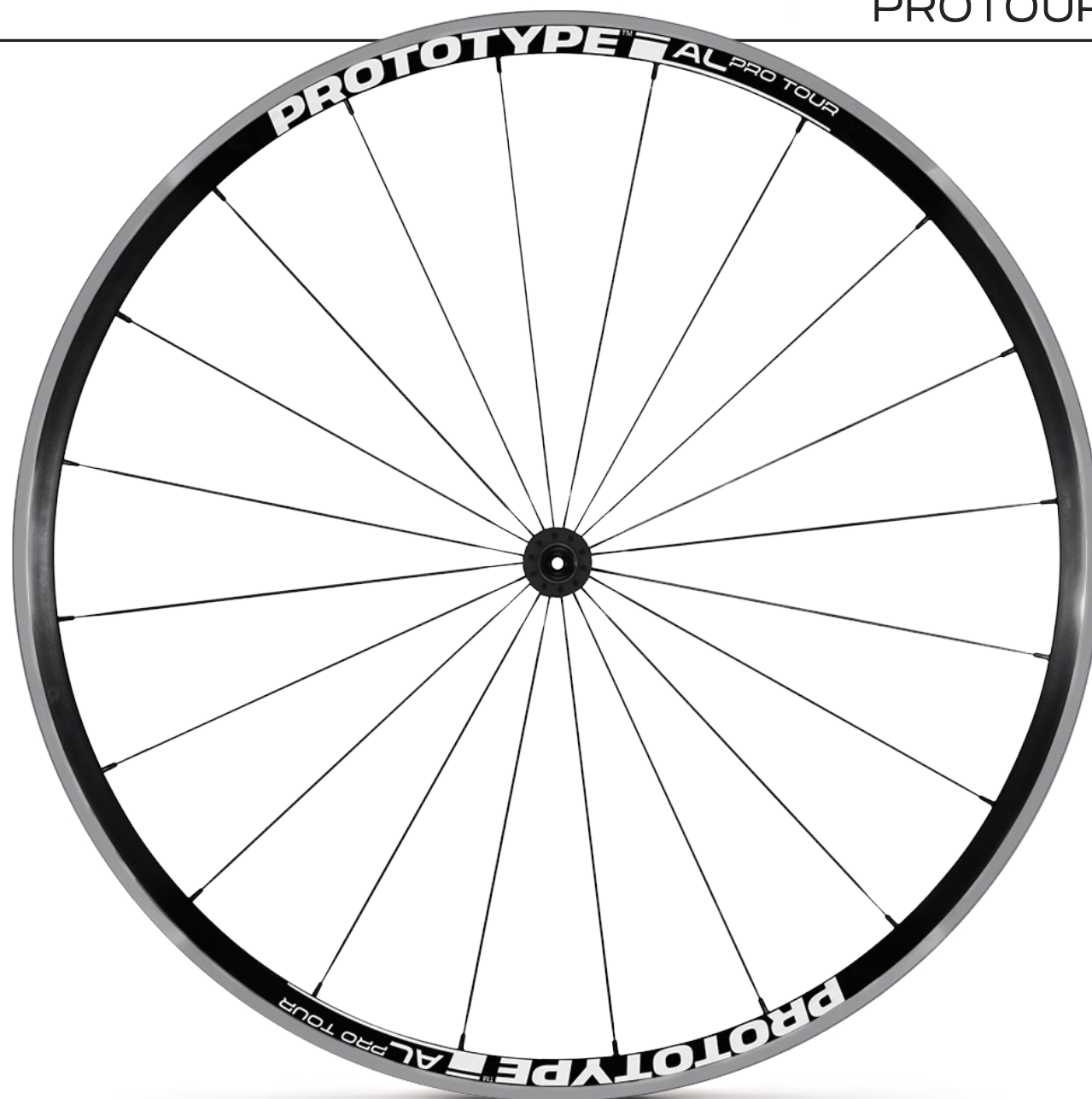

WHEELS PROTOTYPE TRUE INSPIRATION

SOME HEROES IN ACTION



WHEELS TIME TRIAL TRIATHLON

All wheels are build with unmatched attention to detail, we use high-precision tools, specially designed for us. We can offer a ride quality and durability that cannot be matched by a stock machine-built set.

Ivo Santos

Prototype Technical Department



WHEELS TIME TRIAL TRIATHLON JOKER 8

CARBON



THE TEAMS CHOICE



Reference weight:
Front: 690gr

MSRP: 625 €

Reference weight:
Rear: 805gr

MSRP: 750 €

C A R B O N

WHEELS TIME TRIAL TRIATHLON
JOKER DISC



Reference weight:

Tubular: 1210gr

MSRP: 1550 €

CYCLOCROSS WHEELS

“Light, stiff and incredibly smooth. In such a tough discipline as cyclocross, a total confidence on your material is essential. And that confidence is what the new Prototype CX wheels can offer to me.

Aida Nuño

Cyclocross World Cup Athlete

C A R B O N

OPTION Brake



HUB Detail



Reference weight:
Clincher: 1430gr
Tubular: 1190gr

MSRP: 1270 €

CYCLOCROSS WHEELS
AL

ALUMINIUM



HUB Detail



Reference weight:
Clincher: 1740gr
MSRP: 830 €

TECHNICAL SPECIFICATIONS MTB WHEELS

	World Cup	Carbon Team	Carbon SL	Carbon Zero	Zenith Team	Zenith	RW	Zero
Rim Material	Full Carbon	Full Carbon	Full Carbon	Full Carbon	Aluminium	Aluminium	Aluminium	Aluminium
Rim Width Inner/Outer	27/32	25/30	19/23	25/30	25/28	22/25	25/27	22/25
Profile	30	26	24	25	16	18	18	17
Tire Size / Width	29" / 2.0 to 2.5	29" / 2.0 to 2.5	29" / 1.5 to 2.1	29" / 2.0 to 2.5	29" / 2.0 to 2.2	29" / 1.7 to 2.1	29" / 1.8 to 2.5	29" / 1.0 to 2.1
Tire Type	Tubeless ready	Tubeless ready	Tubeless ready	Tubeless ready	Tubeless ready	Tubeless ready	Tubeless ready	Tubeless ready
Spoke	Aero SL 2.0 SP	Aero SL 2.0 - J bend	Aero SL 2.0 - J bend	Round - J Bend	Aero SL 2.0 - J Bend	Round - J Bend	Round - J Bend	Round - J Bend
Nipple	Aluminium	Aluminium	Aluminium	Aluminium	Aluminium	Aluminium	Aluminium	Aluminium
Hub Model*	EVO 4/ EVO 4 SP	EVO 3.1	EVO 4	FSL 3.0	EVO 4	EVO 3.1	FSL 3.0	FSL 3.0
Freewheel Body	SH 11 / XD	SH 11 / XD	SH 11 / XD	SH 11 / XD	SH 11 / XD	SH 11 / XD	SH 11 / XD	SH 11 / XD
Braking	Disc Brake IS	Disc Brake IS	Disc Brake IS	Disc Brake IS	Disc Brake IS	Disc Brake IS	Disc Brake IS	Disc Brake IS
ASTM **	3	3	3	3	3	3	3	3
Discipline	XCO / XCM	XCO / XCM	XCO / XCM	XCO / XCM	XCO / XCM	XCO / XCM	XCO / XCM	XCO / XCM
Weight Limit	100kg	90kg	85kg	100kg	85kg	85kg	110kg	95kg
Weight (Boost)	1430gr	1400gr	1230gr	--gr	1490gr	1460gr	1730gr	1720gr

ROAD WHEELS

	Pro Tour 2 SL	Pro Tour 3 SL	Pro tour 5 SL	Pro Tour 3	Pro tour 5	Prou Tour AL	Pro tour CA
Rim Material	Full Carbon	Full Carbon	Full Carbon	Full Carbon	Full Carbon	Aluminium	Aluminium-Carbon
Rim Width Inner/Outer	23	23	23	25	25	23	23
Profile	20	38	50	38	50	26	38
Tire Size / Width	700x19c/23c	700x19c/25c	700x19c/25c	700x19c/25c	700x19c/25c	700x21c/25c	700x21c/25c
Tire Type	Tubular	Tubular	Tubular	Clincher	Clincher	Clincher	Clincher
Spoke	Aero SL 2.0 SP	Aero SL 2.0 SP	Aero SL 2.0 SP	Aero 2.0 SP	Aero 2.0 SP	Round - J Bend	Round - J Bend
Nipple	Aluminium	Aluminium	Aluminium	Aluminium	Aluminium	Aluminium	Aluminium
Hub Model*	SP 1	SP 1	SP 1	SP 1	SP 1	SPEED 16	SPEED 16
Freewheel Body	SH / XDR / Campy	SH / XDR / Campy	SH / XDR / Campy	SH / XDR / Campy	SH / XDR / Campy	SH / XDR / Campy	SH / XDR / Campy
Braking	Calliper	Calliper	Calliper	Calliper	Calliper	Calliper	Calliper
ASTM **	1	1	1	1	1	1	1
Discipline	Road	Road	Road	Road	Road	Road	Road
Weight Limit	75kg	80kg	85kg	100kg	85kg	85kg	110kg
Weight (Boost)	990gr	1120gr	1180gr	1425gr	1520gr	1590gr	1720gr

* - Consult hub compatibility in our web site

** - Consult ASTM in our web site

TECHNICAL SPECIFICATIONS ROAD DISC WHEELS

	Pro Tour Disc AL	Pro Tour Disc 3	Pro Tour Disc 5
Rim Material	Aluminium	Full Carbon	Full Carbon
Rim Width Inner/Outer	20 / 27	20 / 27	20 / 27
Profile	30	30	50
Tire Size / Width	700x19/27c Tubeless Ready	700x19/27c Tubeless Ready	700x19/27c Tubeless Ready
Tire Type	Clincher	Clincher	Clincher
Spoke	Round	Aero	Aero
Nipple	Aluminium	Aluminium	Aluminium
Hub Model*	SP Disc	SP Disc	SP Disc
Freewheel Body	SH / XDR / Campy	SH / XDR / Campy	SH / XDR / Campy
Braking	IS or Center-Lock	IS or Center-Lock	IS or Center-Lock
ASTM **	1	1	1
Discipline	Road	Road	Road
Weight Limit***	100kg	110kg	120kg
Weight	1560gr	1425gr	1560gr

TIME TRIAL TRIATHLON WHEELS CYCLOCROSS WHEELS

	Joker 8 Front	Joker 8 Rear	Joker Disc	CX Tubular	CX Clincher
Rim Material	Full Carbon	Full Carbon	Full Carbon	Full Carbon	Full Carbon
Rim Width Inner/Outer	23	23	23	25	27
Profile	88	88	-	30	30
Tire Size / Width	700x19c/25c	700x19c/25c	700x19c/25c	700x23/32c	700x23/32c
Tire Type	Tubular	Tubular	Tubular	Tubular	Clincher
Spoke	Aero SL 2.0 SP	Aero SL 2.0 SP	Full Carbon	Round SL	Round SL
Nipple	Aluminium	Aluminium	Aluminium	Aluminium	Aluminium
Hub Model*	SP 1	SP 1	SP 1	SP Disc	SP Disc
Freewheel Body	-	SH / XDR Campy	SH / XDR Campy	SH / XDR / Campy	SH / XDR / Campy
Braking	Calliper	Calliper	Calliper	IS or Center-Lock	IS or Center-Lock
ASTM **	1	1	1	2	2
Discipline	Road	Road	Road	CX / Gravel	CX / Gravel
Weight Limit	100kg	100kg	100kg	85kg	85kg
Weight	690gr	805gr	1210gr	1190gr	1430gr

* - Consult hub compatibility in our web site

** - Consult ASTM in our web site

*** - Weight Limit = rider weight + complet bike

HUBS MTB ROAD

I love how easy it is to make everything perfect mechanically speaking. They are lightweight, unbreakable and very efficient!

Litu Team Manager

MMR Factory Racing Team

BOOST110
By **PROTOTYPE**

B10-03-022

HUBS MTB

Flange spacing has been designed for minimal difference in spoke tension between right and left side spokes. Freewheel with four "Big Pawls" to evenly distribute the loads on a large surface.

FRONT

EVO 4 BOOST

Color: Black
Rotor Compatibility: IS - 6Bolt
Bearings: Prototype PRO 2
Optional: Ceramic Bearings
Holes: 28 | 32
O.L.D: 9x100 | 15x100mm
(15x110 RS-1 adaptor)
Weight: 109gr



MSRP: 145 €

FSL 3.0

Color: Black
Rotor Compatibility: IS - 6Bolt
Bearings: Prototype PRO 2
Holes: 32
O.L.D: 9x100 | 15x100mm
Weight: 122gr



MSRP: 80 €

FSL 3.0 110



O.L.D: 15x110mm
Weight: 152gr

LEFTY

Color: Black
Rotor Compatibility: IS - 6Bolt
Bearings: Prototype PRO 2
Optional: Ceramic Bearings
Holes: 28 | 32
Weight: 114gr (alloy bolt)



MSRP: 145 €

BACK

EVO 4 BOOST

Color: Black
Rotor Compatibility: IS - 6Bolt
Bearings: Prototype PRO 2
Optional: Ceramic Bearings
Holes: 28 | 32
O.L.D: 10x135 | 12x142mm
Cassette body: Shimano 10|11s
Optional: Sram XD
Weight: 239gr (XD)



MSRP: 255 €

FSL 3.0

Color: Black
Rotor Compatibility: IS - 6Bolt
Bearings: Prototype PRO 2
Holes: 32
O.L.D: 10x135 | 12x142mm
Cassette body: Shimano 10|11s
Optional: Sram XD
Weight: 260gr



MSRP: 180 €

FSL 3.0 148



O.L.D: 12x148mm
Weight: 283gr

LEFTY SUPERMAX

Color: Black
Rotor Compatibility: IS - 6Bolt
Bearings: Prototype PRO 2
Optional: Ceramic Bearings
Holes: 28 | 32
Weight: 124gr (alloy bolt)



MSRP: 145 €

HUBS ROAD

FRONT

SP 2 (Straigh Pull)

Color: Black
 Bearings: Prototype PRO 2
 Optional: Ceramic Bearings
 Holes: 20
 O.L.D.: 9x100mm
 Weight: 78gr



MSRP: 125 €

SP Disc

Color: Black
 Rotor Compatibility: IS - 6Bolt
 Bearings: Prototype PRO 2
 Optional: Ceramic Bearings
 Holes: 24
 O.L.D.: 9x100mm | 12x100mm | 15x100
 Weight: 110gr



MSRP: 125 €

Speed 20

Color: Black
 Bearings: Prototype PRO
 Holes: 20
 O.L.D.: 9x100mm
 Weight: 82gr



MSRP: 80 €

BACK

SP 2 (Straigh Pull)

Color: Black
 Rotor Compatibility: IS - 6Bolt
 Bearings: Prototype PRO 2
 Optional: Ceramic Bearings
 Holes: 24
 O.L.D.: 9x130mm
 Cassete body: Shimano 10|11s
 Optional: Campagnolo
 Weight: 188gr



MSRP: 265 €

SP Disc

Color: Black
 Rotor Compatibility: IS - 6Bolt
 Bearings: Prototype PRO 2
 Optional: Ceramic Bearings
 Holes: 24
 O.L.D.: 9x135 | 12x142mm
 Cassete body: Shimano 10|11s
 Weight: 220gr



MSRP: 270 €

IS version also available



BRAKE OPTION
 6 holes (IS)

Speed 20

Color: Black
 Bearings: Prototype PRO
 Optional: Ceramic Bearings
 Holes: 24
 O.L.D.: 9x130mm
 Cassete body: Shimano 10|11s
 Optional: Campagnolo
 Weight: 200gr



MSRP: 180 €

HUBS ACCESSORIES

Spare parts

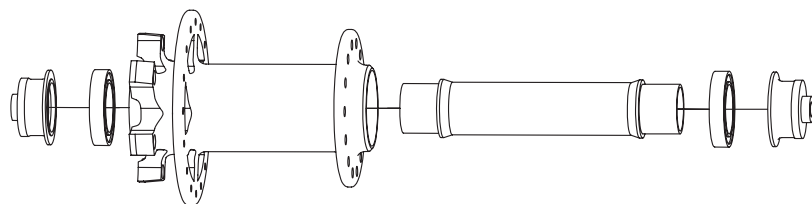

PRO 2 Bearings
Optional: Ceramic Bearings



Kit converts Evo 3/3.1 to RS1



Front CAP Set
9x100mm | 15x100mm | 15x110mm | RS1



Technical Support
available at
www.prototype.pt/support/

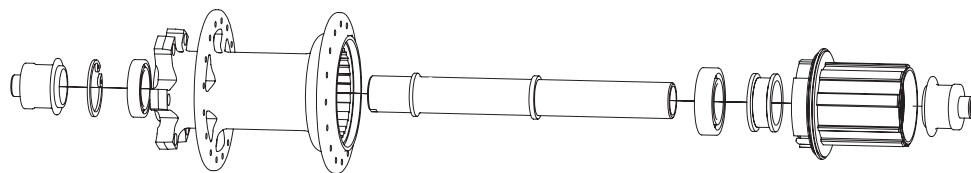

Rear CAP Set
9x135mm | 12x142mm | 12x148mm



Shimano 10/11S



SRAM XD

WHEELS ACCESSORIES

Road Brake Pads

These brake pads have been tested and approved for use with Prototype wheels.



AL PRO

Brake Power Dry:	9
Brake Power Wet	6
Longevity	8
Modulation	7
Temperature	6
Rim friendly	9

Alloy Rim

MSRP: 10 €



CARBON PRO 2

Brake Power Dry:	9
Brake Power Wet	8
Longevity	6
Modulation	7
Temperature	7
Rim friendly	9

Carbon Rim

MSRP: 19 €



CARBON PRO 3

Brake Power Dry:	9
Brake Power Wet	8
Longevity	6
Modulation	7
Temperature	7
Rim friendly	9

Carbon Rim

MSRP: 19 €



Weight: MTB - 71gr
Weight: Road - 69gr

MSRP: 32 €

Valve Exten.

Material: Aluminum
Weight: 1.8gr each
Extend: 32mm
Color: Black Anodized
Item: Include 2 pcs



Only
1.8grams
per wheel.

MSRP: 6 €

TR Valves

Material: Aluminum
with steel nut
Weight: 4.2gr
Height: 44mm
Rubber Shape: Conic Round
Color: Black or Red anodized



Removable
Core

50% Lighter

Available colors



MSRP: 8.50 €

Material: Brass
Weight: 8.4gr
Height: 40mm
Rubber Shape: Conic Round
Color: Silver



Removable
Core

MSRP: 6 €

TR Rim Tape

Width: 23 / 25 / 27 / 29 mm
Length: 5mts



MSRP: 7.50 €

Sealant

Capacities: 150ml/500ml/5Lts



MSRP 150ml: 8.80 €

MSRP 500ml: 17 €

COMPONENTS PHYSIS CARBON

Handlebar



The ability to absorb vibrations is critical to reduce fatigue while stiffness is essential for the perfect control of a bike. Though very light, Physis handlebar is rigid and strengthened in grip areas.

Length: 660mm/710 mm | 720mm (Team)
Material: Aluminum Light Force
Weigh: 270gr | 187gr (Team)

MSRP: 53 € | 84 € (Team)

Stem



Being the stem a key element for the perfect fit for riders' position, Physis stem distinguishes itself by its design, construction materials and vibration absorption capacity.

Length: 6° and 17° > 80 mm ~ 130mm
Material: Aluminum Light Force
Bolts: Titanium
Weigh: 6° - 98gr (90mm) / 17° - 100gr (90mm)

MSRP: 68 €

Seat Clamp



Dimensions: 31.8 / 34.9 / 36.0 / 38.2
Material: Aluminum Light Force
Weight: 5.9gr (38.2)

Available colors



MSRP: 20 €

Extensions



Length: 75mm
Material: Aluminum Light Force
Weight: 46gr

Available colors



MSRP: 29.50 €

Seat Post



Length: 410 mm: 100-310mm
Material: Aluminum Light Force
Weight: 27.2 x 410 mm > 205 gr
31.6 x 410 mm > 167 gr
30.9 x 410 mm > 185 gr

Available colors



MSRP: 95 €

Handlebar



The ability to absorb vibrations is critical to reduce fatigue while stiffness is essential for the perfect control of a bike. Though very light, Physis handlebar is rigid and strengthened in grip areas.

Length: 660mm/710 mm | 720mm (Team)
Material: Aluminum Light Force
Weight: 270gr | 187gr (Team)

MSRP: 53 € | 84 € (Team)

Stem



Being the stem a key element for the perfect fit for riders' position, Physis stem distinguishes itself by its design, construction materials and vibration absorption capacity.

Length: 6° and 17° > 80 mm ~ 130mm
Material: Aluminum Light Force
Bolts: Titanium
Weight: 6° - 98gr (90mm) / 17° - 100gr (90mm)

MSRP: 68 €

Seat Clamp



Dimensions: 31.8 / 34.9 / 36.0 / 38.2
Material: Aluminum Light Force
Weight: 5.9gr (38.2)

Available colors



MSRP: 20 €

Extensions



Length: 75mm
Material: Aluminum Light Force
Weight: 46gr

Available colors



MSRP: 29.50 €

Seat Post



Length: 410 mm: 100-310mm
Material: Aluminum Light Force
Weight: 27.2 x 410 mm > 205 gr
31.6 x 410 mm > 167 gr
30.9 x 410 mm > 185 gr

Available colors



MSRP: 95 €

COMPONENTS BOTTOM BRACKET

Our bottom brackets feature high quality sealed cartridge bearings

BSA



Frame Type: BB BSA 1.37x24
Crankset: Shimano, FSA, Rotor
CrankSet Axle: 24mm
Bearings: 6805 2RS
Weight: 85gr

MSRP: 39 €

BSA-GPX



Frame Type: BB BSA 1.37x24
Crankset: SRAM GXP Type
CrankSet Axle: 22-24mm
Bearings: 6805 2RS
Weight: 120gr

MSRP: 39 €

BSA 30mm



Frame Type: BB BSA 1.37x24
CrankSet Axle: 30mm
Bearings: 6806 2RS
Weight: 85gr

MSRP: 58 €

PRESSFIT 41



Frame Type: BB 86,5/89.5/92
Frame BB ø: 41mm
CrankSet: Shimano, FSA
CrankSet Axle ø: 24mm
Material: Aluminum CNC
Bearings: 6805 2RS
Weight: 89gr

MSRP: 39.50 €

PRESSFIT 41-GXP



Frame Type: BB 86,5/89.5/92
Frame BB ø: 41mm
CrankSet: SRAM GXP
CrankSet Axle ø: 20-24mm
Material: Aluminum CNC
Bearings: 6805 2RS
Weight: 96gr

MSRP: 39.50 €

PRESSFIT 30



Frame Type: BB PF30
Frame BB ø: 46mm
CrankSet Axle ø: 30mm
Bearings: 6806 2RS
Material: Aluminum CNC
Weight: 112gr

MSRP: 39.50 €

Lightweight, CNC machined, sealed bearing BB. CNC Alloy cups to press into 46mm internal BB shells. Our PF30 bottom bracket is a significant upgrade to any OEM PF30 bottom bracket. Two machined aluminum cups offer increased durability and bearing life, while keeping a simple press together method for installation and maintenance. This means no more creaking, smoother operation, longer bearing life.

PF 41-30mm



Frame Type: BB 86,5/89.5/92
Frame BB ø: 41mm
CrankSet Axle ø: 30mm
Bearings: CNC modified
Weight: 73gr

MSRP: 67 €

ADAPTORS



BB30 to 24mm Shimano
Adapter fits a BB30 of PF30 bearings and reduces the diameter to work with Shimano Hollotech II crank sets.

Weight: 56gr

BB30 to 24mm SRAM GXP

Adapter fits a BB30 of PF30 bearings and reduces the diameter to work with SRAM cranks.

Weight: 70gr

MSRP: 17.50 €

Headset

UPPER SET

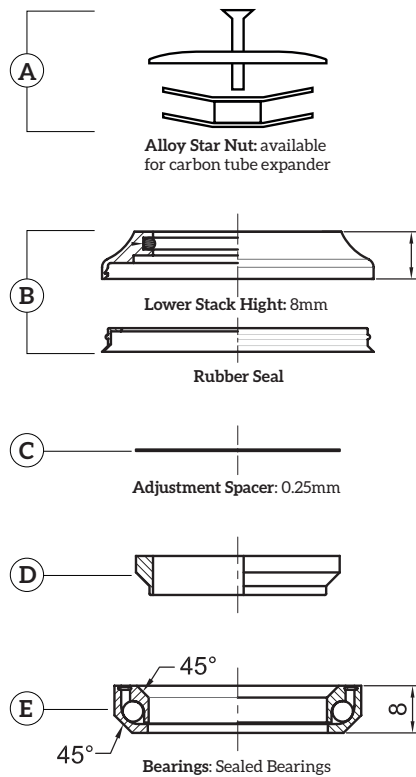

UPPER SET

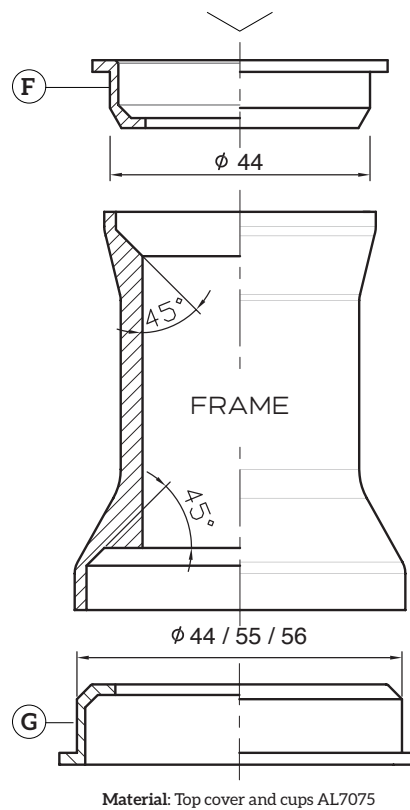

BOTTOM SET

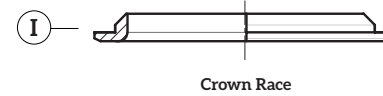
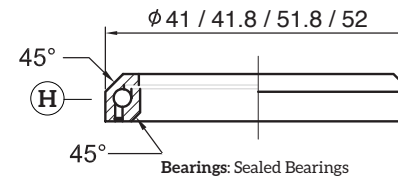
Fork Crown Race
Adaptor 1.5" - 1 1/8"Material: AL7075
Weigh: 12gr.

Lightweight, CNC machined, sealed bearing BB. CNC Alloy cups to press into 46mm internal BB shells. Our PF30 bottom bracket is a significant upgrade to any OEM PF30 bottom bracket.



COMPONENTS HEADSETS

Prototype headsets have a low profile to keep stack height to a minimum keeping the front end low and fast.

Semi-integrated

MSRP: 36 €			
	Standard 1 1/8" - 1 1/8"	Tapered 1 1/8" - 1,5" 55mm	Tapered 1 1/8" - 1,5" 56mm
UPPER BEARING	41.8x45°x8	41.8x45°x8	41.8x45°x8
UPPER CUP	44mm	44mm	44mm
BOTTOM CUP	44mm	55mm	56mm
BOTTOM BEARING	41.8x45°x8	51.8x45°x8	51.8x45°x8
Weight without cap	76gr	90gr	90gr

Integrated

MSRP: 32.50 €				
	Standard 1 1/8" - 1 1/8"	Standard 1 1/8" - 1 1/8"	Tapered 1 1/8" - 1 1/4"	Tapered 1 1/8" - 1,5"
UPPER BEARING	41.0x45°x8	41.8x45°x8	41.8x45°x8	41.8x45°x8
BOTTOM BEARING	41.0x45°x8	41.8x45°x8	46.8x45°x7	51.8x45°x8
Weight without cap	70gr	72gr	74gr	76gr

Spacers

Super Light headset spacers

Spacers are super light. Featuring CnC machined inner grooves. Not a single gram is spared.



Material: Aluminum
Outer ø: 34mm
One Set includes 2pcs: 5 | 10mm
Weight: 5mm: 1.8gr / 10mm: 3.6gr

MSRP: 4.80 €

Bearings

BLACK SHIELD



The quality of steering headset is assessed by sensivity and smoothness throughout its lifetime. maintenance.

Material: Aluminum
Outer ø: 34mm
One Set includes 2pcs: 5 | 10mm
Weight: 5mm: 1.8gr / 10mm: 3.6gr

MSRP: 4.80 €

Headset Cap

Headset Top Cap



Material Cap: AL7075
Material Bolt: M6x35mm AL7075
Material Spider: AL6061 + Steel
Weigh: Top Cap: 3.8gr
Bolt: 2.3gr / Spider: 5.9gr

MSRP: 6.50 €

COMPONENTS TRANSMISSION

Light Force Alloy also provides a high wear resistance even in the worst conditions.

Single Ring

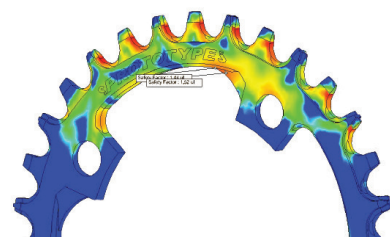

STRESS TEST MATERIAL

We developed a single chain ring in order to convert triple or double crank sets into singles with 10 or 11 speeds.

Narrow wide tooth profiling ensures ultimate chain retention and alignment. CNC machined from a stiff 4 mm Light Force plane, wich provides a perfect power without flexing.



BCD 94 mm
Holes: 4
Teeth: 30, 32, 34

BCD 104 mm
Holes: 4
Teeth: 30, 32, 34, 36

Weigth 32T: 68.8gr

MSRP: 59.50 €

Jockey Wheels



Material: Full CNC machined
Teeth: 11T
Weight: 8.5gr

Available colors



MSRP: 30 € (2ps)

Performance pulley, with low friction and optimized geometry to improve the operation and precision of the rear derailleurs.

Compatible with Shimano, Campagnolo and Sram X-0, XX, Force, Red.

Cassette Lock Ring



Fits: Shimano 11T Cassete Road or MTB
Material: AL7075
Weigth: 5,5gr

Available colors



MSRP: 30 € (2ps)

WORKSHOP

Bearings



High precision ball bearings (Abec5) with hardening surface and anti-corrosion treatment.

General bearing

Dimensions	Designation
5 x 10 x 4	MR105ZZ
5 x 11 x 4	MR115ZZ
8 x 14 x 4	MR148-2RSA3
15 x 26 x 7	MR15267
17 x 28 x 7	MR17287
27.5 x 37 x 7	MR275377 - Predictive
10 x 22 x 6	6900
10 x 26 x 8	6000
12 x 21 x 5	6801
12 x 24 x 6	6901
15 x 24 x 5	6802
15 x 26 x 7	MR
15 x 28 x 7	6902
17 x 26 x 5	6803
17 x 30 x 7	6903
25 x 37 x 7	6805
20 x 32 x 7	6804
30 x 42 x 7	6806

Bottom Bracket bearings

Dimensions	Designation
22 x 36 x 7/15	GXP BSA
24 x 37 x 7	6805MR24
25 x 37 x 7	6805
25 x 42 x 9	6905
30 x 42 x 7	6806
35 x 47 x 7	6807

Headset bearing

Dimensions	Designation
39x6.5x36°	1-1/8"
41x6.5x45°	1-1/8"
41x8x45°	1-1/8"
41.8x6.5x45°	1-1/8"
41.8x8x45°	1-1/8"
46.8x7x45°	1-1/4"
51.8x8x45°	1-1/2"
52x8x45x45°	1-1/2"
19/16 x2x 9° 45°	Lefty 2.0
19/16x2x9°	Lefty

GRIPS



Material: 100% Silicone
Weight: 84gr - Comfort / 59gr - Sport

Available colors



MSRP: 18€ (Comf. or Sport)

M5 - M6 Bolts



Material: Titanium Gr5

M5 Dimensions: 16mm | 20mm | 25mm
Weight: 1,2gr | 1,6gr | 1,7gr

M6 Dimensions: 20mm | 25mm | 35mm | 45mm
Weight: 2gr | 2,2gr | 2,5gr | 3,5gr

Available colors



MSRP: 4.50€ (pc)



Material: Aluminum Light Force

M5 Dimensions: 10mm | 16mm | 20mm
Weight: 1gr | 1,3gr | 1,4gr
Max Torque: 5N.m

M6 Dimensions: 15mm | 20mm | 25mm | 35mm
Weight: 1,6gr | 1,8gr | 2,0gr | 2,8gr
Max Torque: 7N.m

Available colors



MSRP: 2.10€ (pc)

Chainring Bolt



Material: Aluminum Light Force

Small 6,5mm
Weight: 5,8gr

Large 8,5mm
Weight: 7gr

Available colors



MSRP: 13.50€ (4pc)

Bolt SRAM M10



Material: Aluminum Light Force
Weight: 4,1gr

Available colors



MSRP: 25€ (4pc)

PROTOTYPETM RACING PARTS

WWW.PROTOTYPE.PT

TRUE HEROES TRUE INSPIRATION

2019 COLLECTION

PROTOTYPE | Leiria-Portugal
sales@prototype.pt | www.prototype.pt



Telmo Pinão
Para-Cycling Athlete